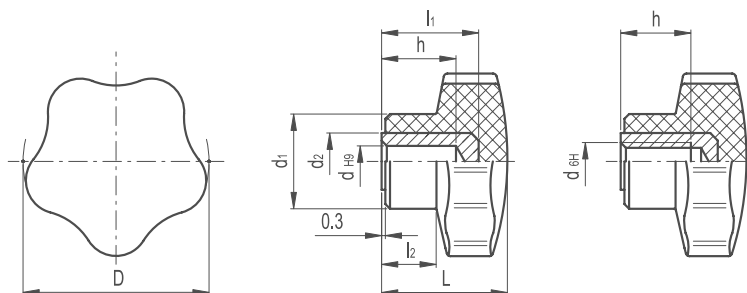

Lobe Knobs

271

KNOB & HANDLES

BODY

- / Phenolic based (PF) Duroplast
- / Resistant to solvents, oils, greases and other chemical agents

COLOUR

- / Black, glossy finish

ASSEMBLY

- / Execution A: black-oxide steel boss, plain blind hole
- / Execution B: brass boss, plain or tapped blind hole

FEATURES

The exclusive five-lobe shape offers the operator's fingers a proper grip and prevents unhealthy residues from depositing thanks to its solid shape without cavities.



Part Reference	D	L	d1	d2	l1	l2	Mounting Hole			Bosses	
							dH9	d 6h	h	Steel	Brass
LBKB1	25	21	15	11	14	9	4	-	11		
LBKB2	25	21	15	-	-	9	-	M4	10		
LBKB3	32	23	19	12	17	11	6	-	14		
LBKB4	32	23	19	-	-	11	-	M5	10		
LBKB5	32	23	19	-	-	11	-	M6	12		
LBKB6	40	27	21	12	17	12	6	-	14		
LBKB7	40	27	21	12	18	12	8	-	14		
LBKB8	40	27	21	-	-	12	-	M6	12		
LBKB9	40	27	21	-	-	12	-	M8	13		
LBKA10	50	33	25	15	23	14	6	-	18		
LBKA11	50	33	25	15	25	14	8	-	20		
LBKA12	50	33	25	16	25	14	10	-	21		
LBKB13	50	33	25	15	23	14	6	-	18		
LBKB14	50	33	25	15	25	14	8	-	20		
LBKB15	50	33	25	-	-	14	-	M8	20		
LBKB16	50	33	25	-	-	14	-	M10	17		
LBKA17	60	37	27	18	28	17	6	-	20		
LBKA18	60	37	27	15	25	17	8	-	20		
LBKA19	60	37	27	18	31	17	10	-	25		
LBKB20	60	37	27	-	-	17	-	M10	17		
LBKB21	60	37	27	-	-	17	-	M12	20		
LBKA22	70	44	30	20	35	20	8	-	26		
LBKA23	70	44	30	18	31	20	10	-	25		
LBKB24	70	44	30	-	-	20	-	M12	20		
LBKB25	70	44	30	-	-	20	-	M14	20		
LBKA26	85	55	35	22	38	30	8	-	25		
LBKB27	85	55	35	-	-	30	-	M16	22		
LBKA28	100	60	38	22	38	31	8	-	25		
LBKA29	100	60	38	-14	-25	31	-	M16	22		