

# Cam Plunger

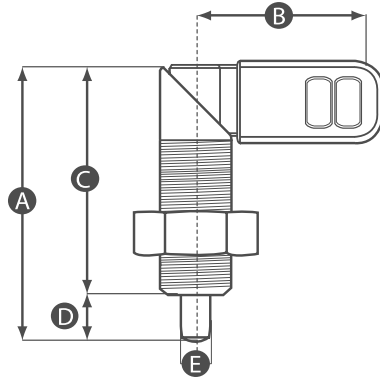

## MATERIAL

/ Blackened steel or stainless steel

## INCLUDES

Comes as standard with locking nut. Stainless steel body comes complete with black plastic cap, burnished steel without cap.



Part No.	A	B	C	D	E	Thread size	Plunger diameter (mm)	Body material	Includes cap
CL8M12	47	32	39	8	8	M12x1.5	8	Blackened steel	No
CL8M20	69	37	36	12	8	M20x1.5	8	Blackened steel	No
CL10M20	69	37	36	12	10	M20x1.5	10	Blackened steel	No
CL12M20	69	37	36	12	12	M20x1.5	12	Blackened steel	No
CL8M20SS	69	52	36	12	8	M20x1.5	8	Stainless steel	Yes
CL10M20SS	69	52	36	12	10	M20x1.5	10	Stainless steel	Yes
CL12M20SS	69	52	36	12	12	M20x1.5	12	Stainless steel	Yes