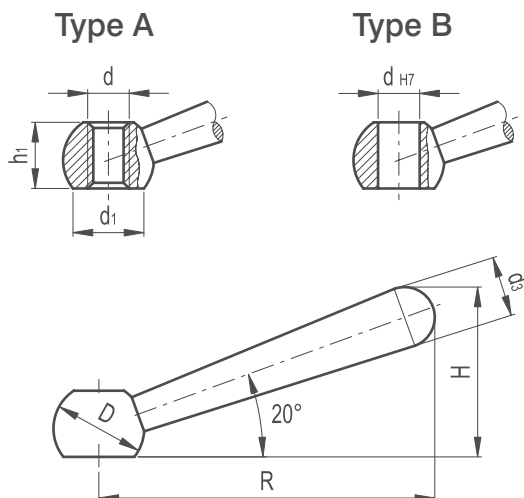

Clamping Lever Turned and Blacked

217

KNOB & HANDLES

MATERIAL

/ Turned and black-oxide steel.

ASSEMBLY

/ Type B: plain through hole.

/ Type A: tapped through hole.



Part Reference	R	D	H	d1	d3	dH7	Mounting Hole	
							d	h1
CL1B	48	12	24	11	8	6	-	9.5
CL2A	48	12	24	11	8	-	M6	9.5
CL3B	60	16	30.5	12.5	10	8	-	12
CL3A	60	16	30.5	12.5	10	-	M8	12
CL5B	76	20	38	16	13	10	-	14.5
CL6A	76	20	38	16	13	-	M10	14.5
CL7B	95	25	47	20	16	12	-	18.5
CL8A	95	25	47	20	16	-	M12	18.5
CL9B	119	32	59.5	25	20	16	-	24
CL10A	119	32	59.5	25	20	-	M16	24
CL11B	152	40	76	31	25	20	-	30
CL12A	152	40	76	31	25	-	M20	30