

# Ball Knobs

## Tapped Brass Hole

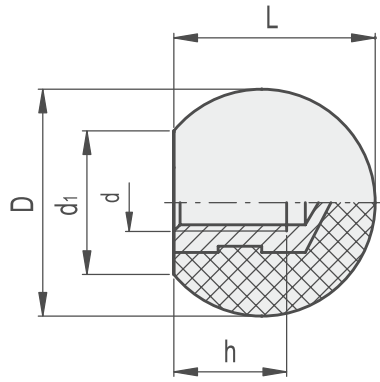

**MATERIAL**  
/ Phenolic based (PF) Duroplast  
/ Resistant to solvents, oils, greases and other chemical agents

**COLOUR**  
/ Black, glossy finish

**STANDARD EXECUTION**  
Brass boss, tapped blind hole.



Part Ref.	Description	D	L	d1	d	hmin.	Weight (g)
BKBB1	20 B-M4	20	18	12	M4	12	9
BKBB2	20 B-M5	20	18	12	M5	10	9
BKBB3	20 B-M6	20	18	12	M6	10	9
BKBB4	25 B-M6	25	22.5	15	M6	10	13
BKBB5	25 B-M8	25	22.5	15	M8	16	18
BKBB6	25 B-M10	25	22.5	15	M10	15	17
BKBB7	30 B-M5	30	28	15	M5	10	28
BKBB8	30 B-M6	30	28	15	M6	10	27
BKBB9	30 B-M8	30	28	15	M8	16	26
BKBB10	30 B-M10	30	28	15	M10	18	25
BKBB11	32 B-M8	32	29	18	M8	16	22
BKBB12	32 B-M10	32	29	18	M10	18	21
BKBB13	35 B-M8	35	32.5	18	M8	16	32
BKBB14	35 B-M10	35	32.5	18	M10	18	30
BKBB15	40 B-M8	40	37	22	M8	16	35
BKBB16	40 B-M10	40	37	22	M10	18	45
BKBB17	40 B-M12	40	37	22	M12	27	43
BKBB18	45 B-M10	45	42.5	22	M10	18	55
BKBB19	45 B-M12	45	42.5	22	M12	27	60
BKBB20	50 B-M8	50	46	27	M8	16	98
BKBB21	50 B-M10	50	46	27	M10	18	100
BKBB22	50 B-M12	50	46	27	M12	27	107